

principal in charge:  
daniel c. osborn

interior designer:  
beth philyaw norris

project manager:  
james a. brown

structural engineer:  
hodnett/hurst engineers

mechanical engineer:  
engineering solutions

electrical engineer:  
o&s enterprises

project data:  
40,800 sf  
\$3.2 million  
august 2007

# Bonner Wing Renovation

## A&M University - Normal, AL

The Bonner Wing of the Carver Complex at A&M University is a typical 1960s college classroom and lab building. Not only is the building difficult functionally, but the original HVAC systems were in bad disrepair. The primary emphasis of this renovation was to replace the HVAC and plumbing systems, upgrade the electrical system, create ADA compliant restrooms and to install new finishes in the building.

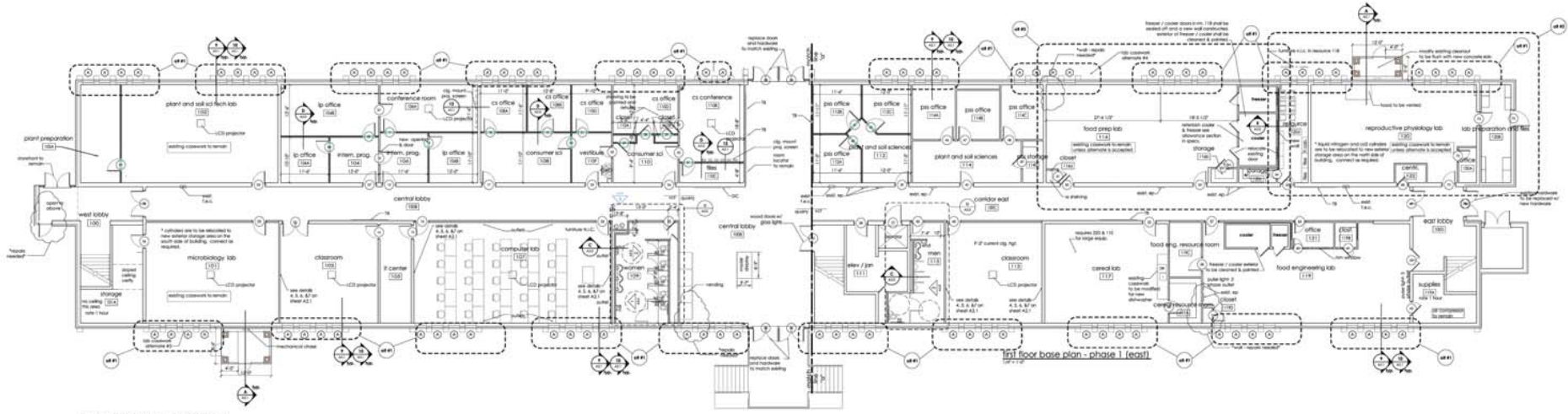

first floor base plan - phase 2 (west)